

NGPS2525PJ1R575G1A1F

1575.42 MHz GPS & GLONASS Patch Antenna



Applications

NGPS2525PJ1R575G1A1F is a Patch Antenna designed for GPS & GLONASS applications. It operates within the frequency of 1575.42 MHz making it perfect for use in Navigation and Fleet Tracking

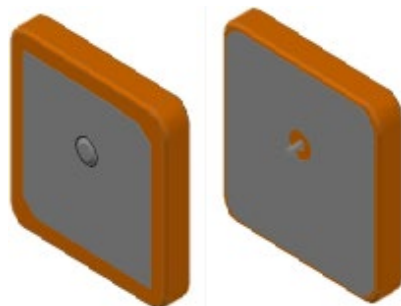

Features

- High Gain, Compact
- Pin Type
- RoHs Complaint

Part Number Breakdown

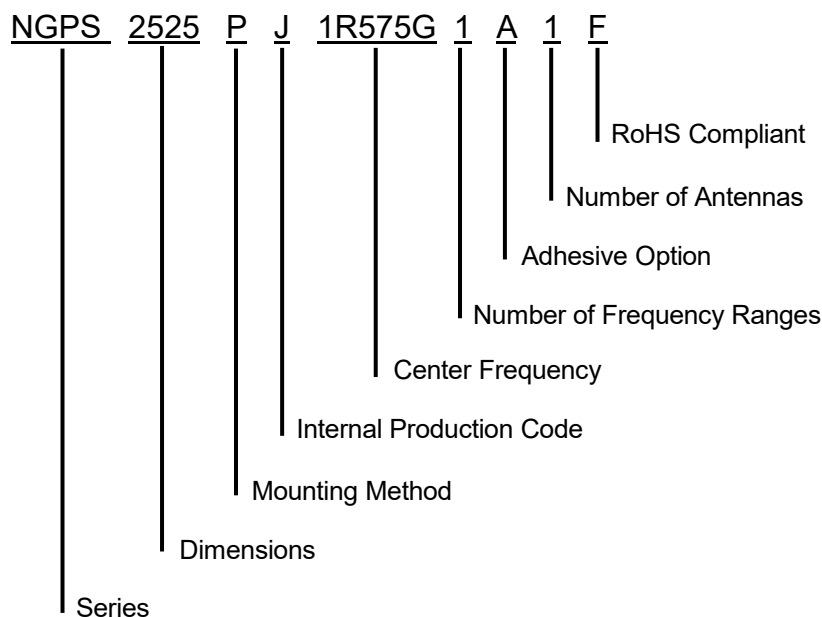

Specifications

Electrical	
Frequency Range	1575.42 MHz \pm 3.0 MHz
Return Loss @ F0	\geq 25 dB typ.
Bandwidth @ 10 dB Return Loss	\geq 8 dB typ.
Gain @ Zenith	2 dBi typ.
Polarization	RHCP
Impedance	50 Ω
Environmental	
Operating Temperature	-40°C~+85°C
Frequency Temperature Coefficient	\pm 20 ppm/ °C
RoHS Complaint	Yes

Dimension Drawing

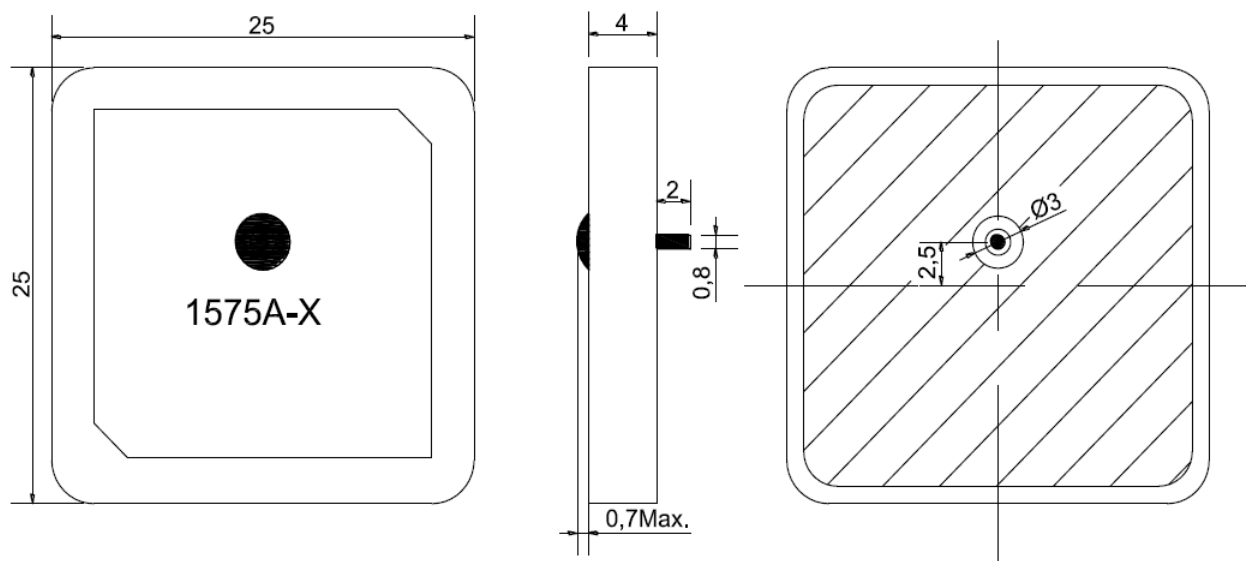

Tolerance Unless Otherwise Specified: \pm 0.30
Unit: mm

NGPS2525PJ1R575G1A1F

1575.42 MHz GPS & GLONASS Patch Antenna



Test Fixture

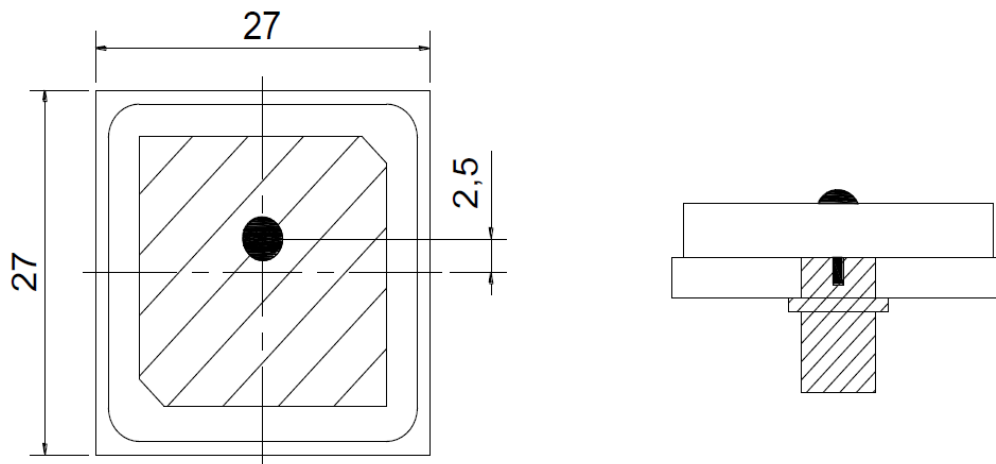

Antenna Patterns

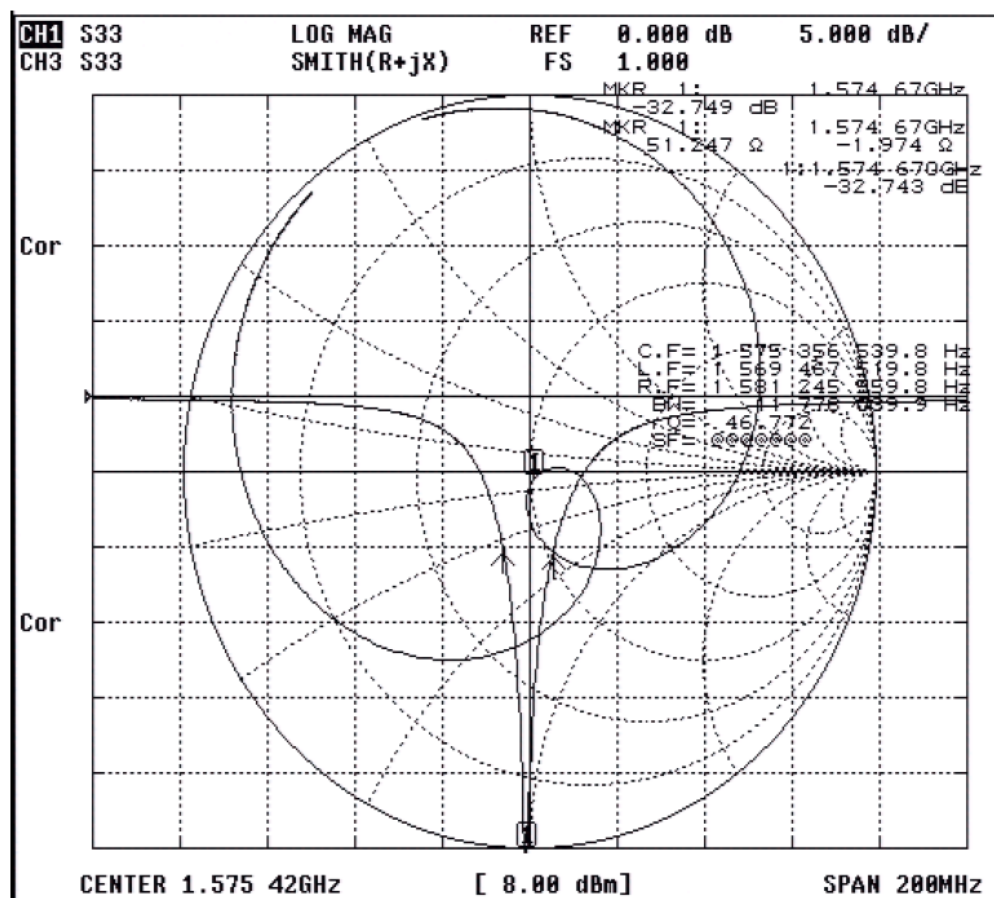

Performance Passives By Design

NIC Components Corp.
100 Baylis Road. Melville, NY 11747

Page 3
www.niccomp.com

Last Updated 2/6/2025. Specification subject to change without notice. Please check web site or contact NIC for latest information