

# NGPS1818PJ1R575G2A1F

## GPS & GLONASS Patch Antenna



### Description

NGPS1818PJ1R575G2A1F is a Patch Antenna designed for GNSS L1 applications. It operates within the frequency range of 1575.42 ~ 1602MHz making it perfect for use in Navigation and Fleet Tracking

### Features

- High Gain, Compact
- Pin Type
- RoHs Complaint

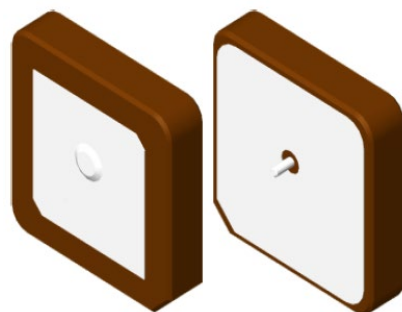

### Part Number Breakdown

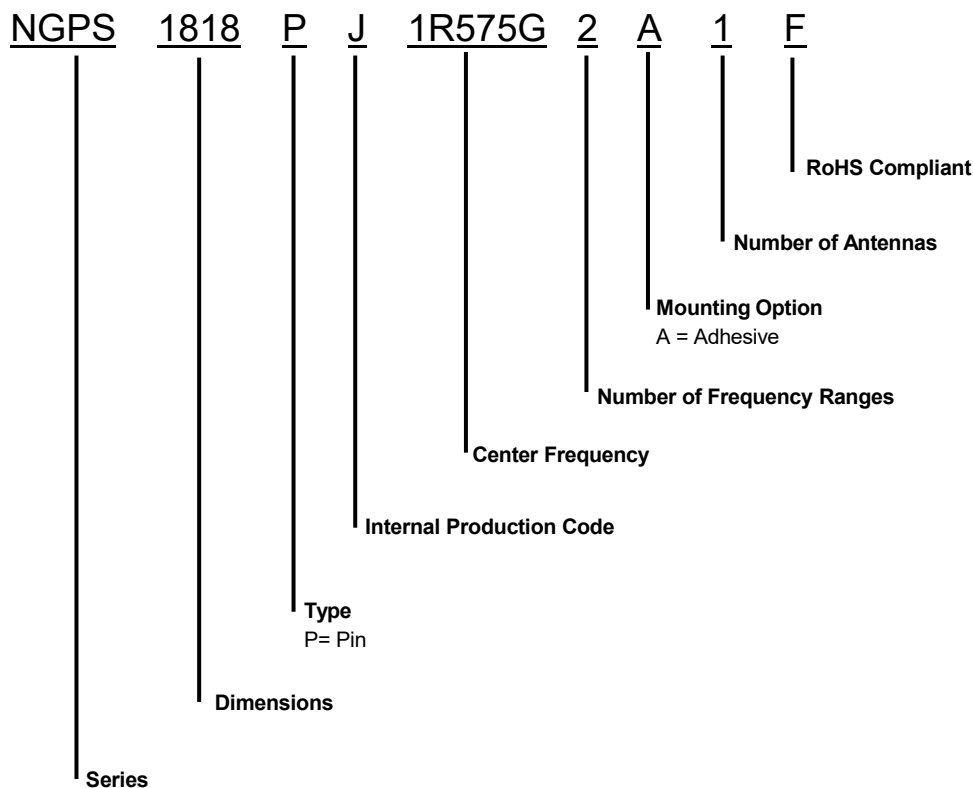

# NGPS1818PJ1R575G2A1F

## GPS & GLONASS Patch Antenna



### Specifications

Electrical	
Frequency Range	1575.42 MHz 1602 MHz
Return Loss @ F0	≥ 10 dB
Gain	-
Polarization	RHCP
Impedance	50Ω
Environmental	
Operating Temperature	-40°C~+85°C
Ground Plane	50 x 50 mm
RoHS Compliant	Yes

### Dimensions

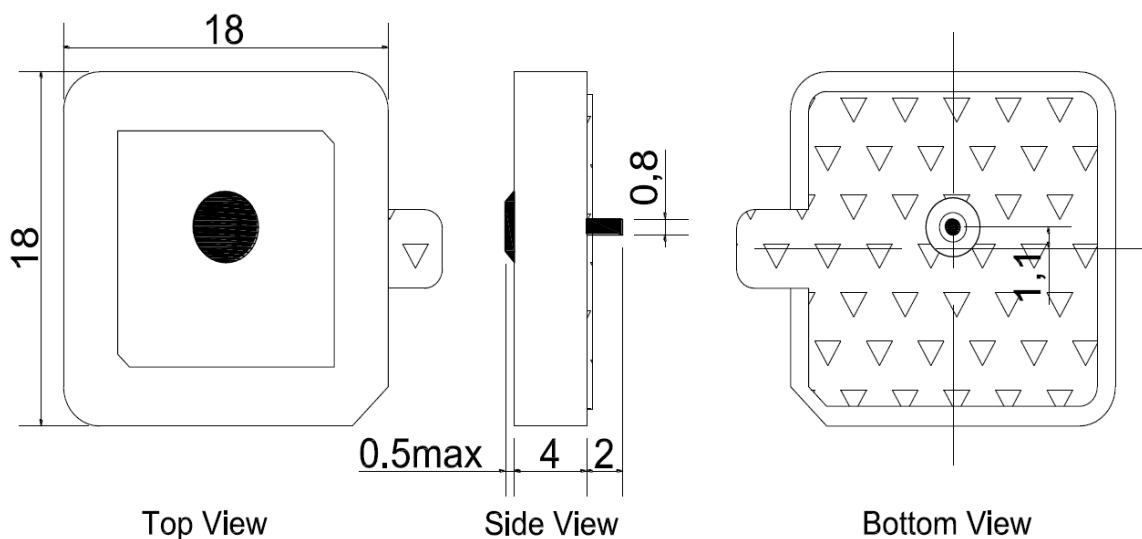

Tolerance Unless Otherwise Specified: ±0.20  
Unit: mm

# NGPS1818PJ1R575G2A1F

## GPS & GLONASS Patch Antenna



### Test Fixture

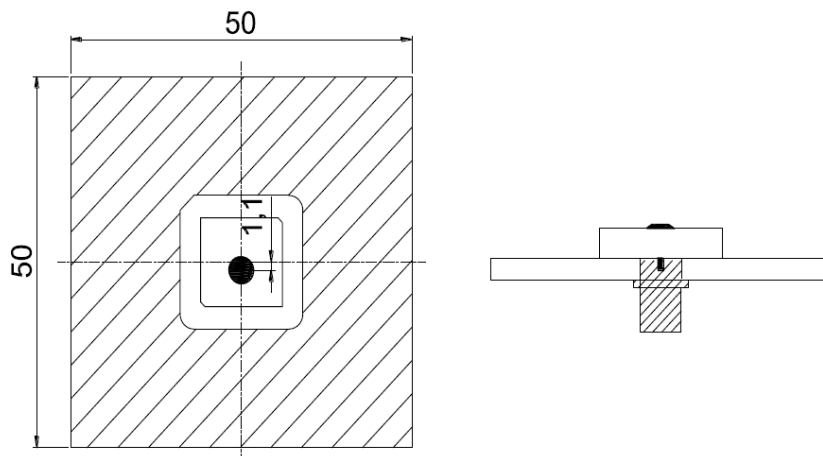

### Antenna Patterns

