

NANE81X14PJC2CF

698 & 1710 MHz LTE External Antenna



Description

The NANE81X14PJC2CF is an external active antenna designed for dual-band LTE applications. It operates within the frequency ranges of 698~960 MHz and 1710~2690 MHz, making it perfect for use in Routers, Gateways, and Meters.

Features

- 698 & 1710 MHz LTE Protocols
- Customizable Cable and Connector Options
- IP67 Waterproof Rating
- RoHs Complaint



Part Number Breakdown

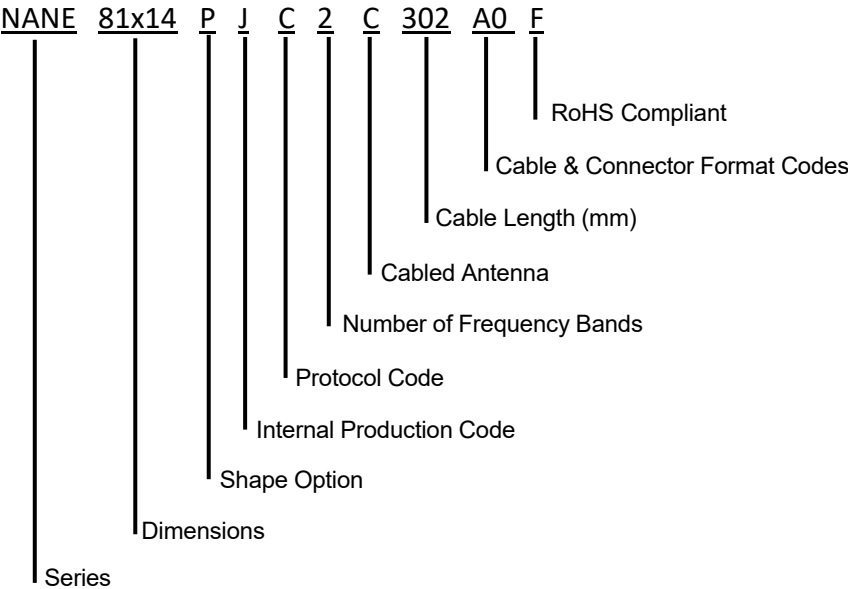

Part Number Options

Part Number	Protocol	Connector	Cable Type	Cable Length
NANE81X14PJC2C302A0F	LTE (C)	SMA MALE	RG174	3000 mm
NANE81X14PJC2C302A1F	LTE (C)	IPEX I	RG178	3000 mm
NANE81X14PJC2C600A1F	LTE (C)	IPEX I	RG178	600 mm
NANE81X14PJC2C502A0F	LTE (C)	SMA MALE	RG174	5000 mm

The table represents assembled part numbers available on www.niccomp.com. For options not listed above please contact NIC

NANE81X14PJC2CF

698 & 1710 MHz LTE External Antenna



Specifications

Electrical		
Frequency Range	698~960 MHz	1710~2690 MHz
Gain	2.5 dBi typ.	
V.S.W.R	< 3.0	
Polarization	Linear	
Impedance	50Ω	
Radome Material	ABS	
Mounting Method	Screw	
Environmental		
Operating Temperature -	-40℃~+85℃	
Relative Humidity	Up to 95%	
Ingress Protection	IP66	
Vibration	10 to 55Hz with 1.5mm amplitude 2hrs	
ROHS Compliant	Yes	

NANE81X14PJC2CF

698 & 1710 MHz LTE External Antenna



Dimensions

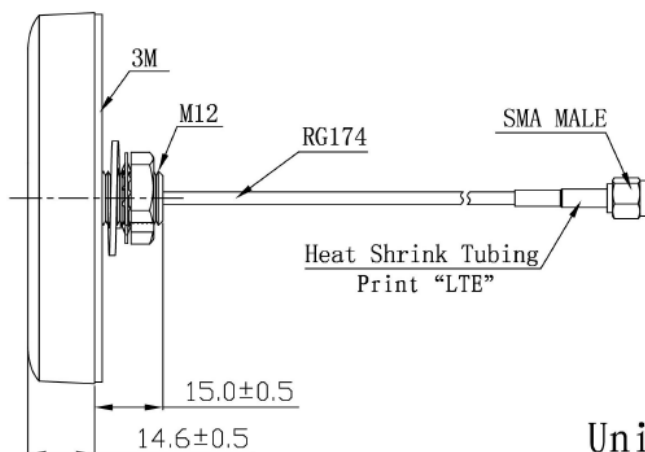
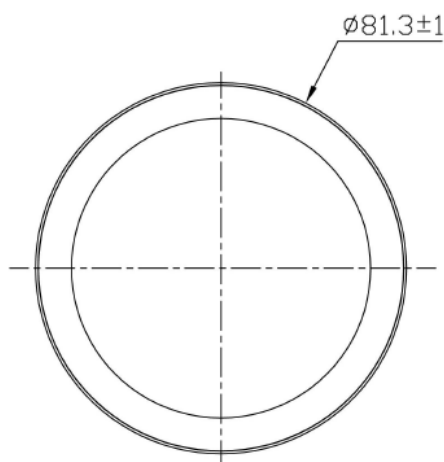

Unit: mm

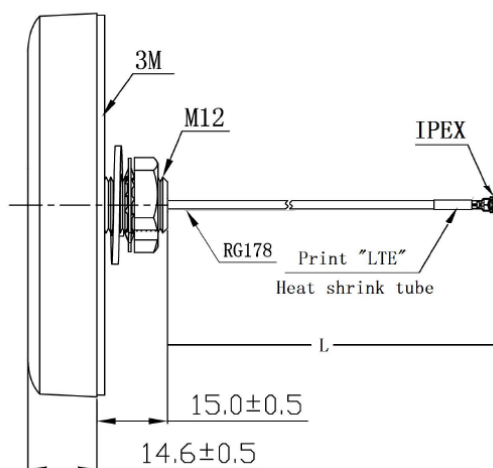
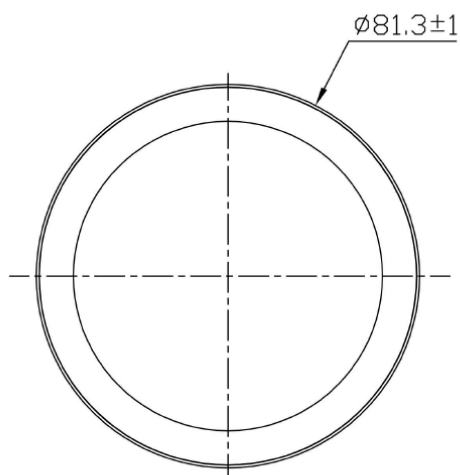

Unit: mm

NANE81X14PJC2CF

698 & 1710 MHz LTE External Antenna



Radiation Patterns

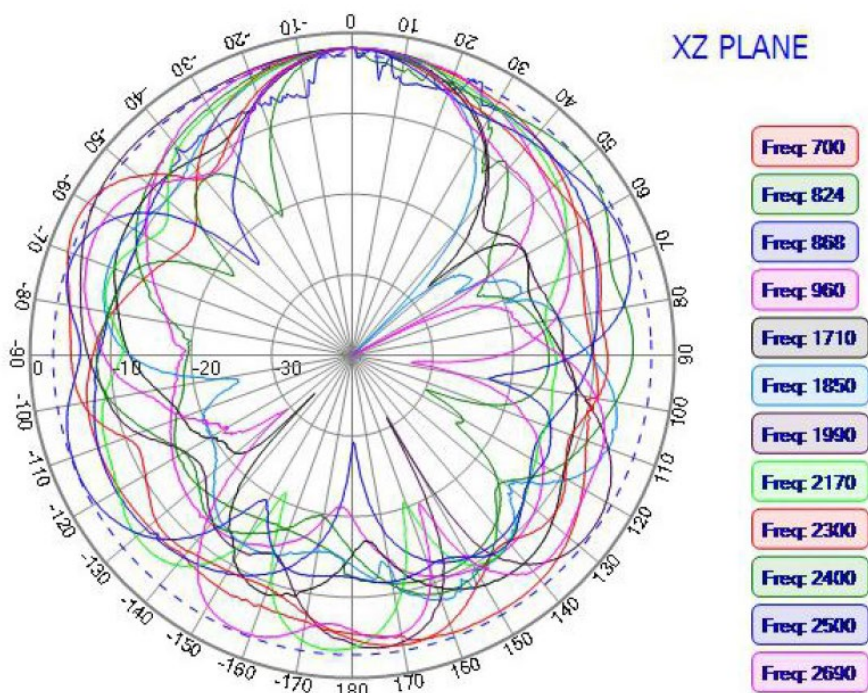
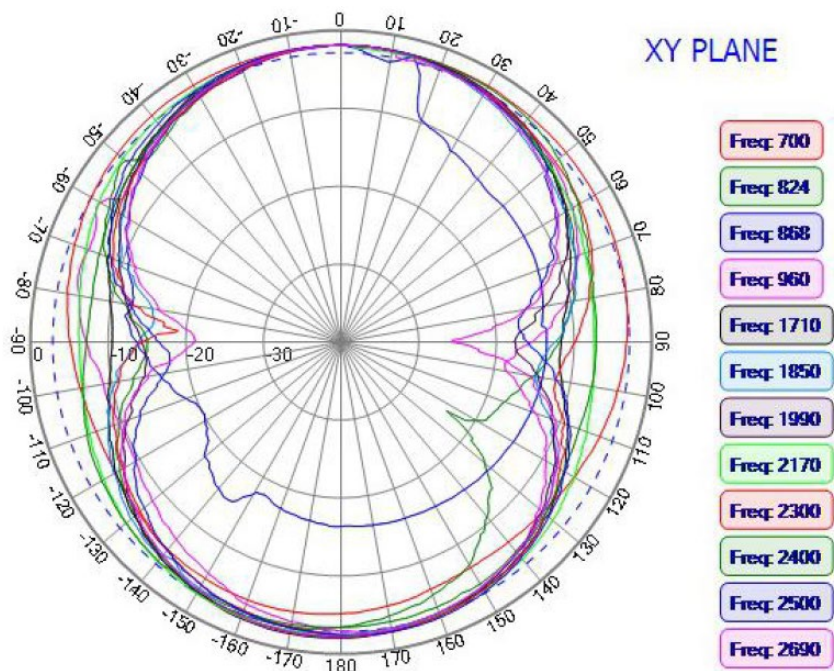

NANE81X14PJC2CF

698 & 1710 MHz LTE External Antenna

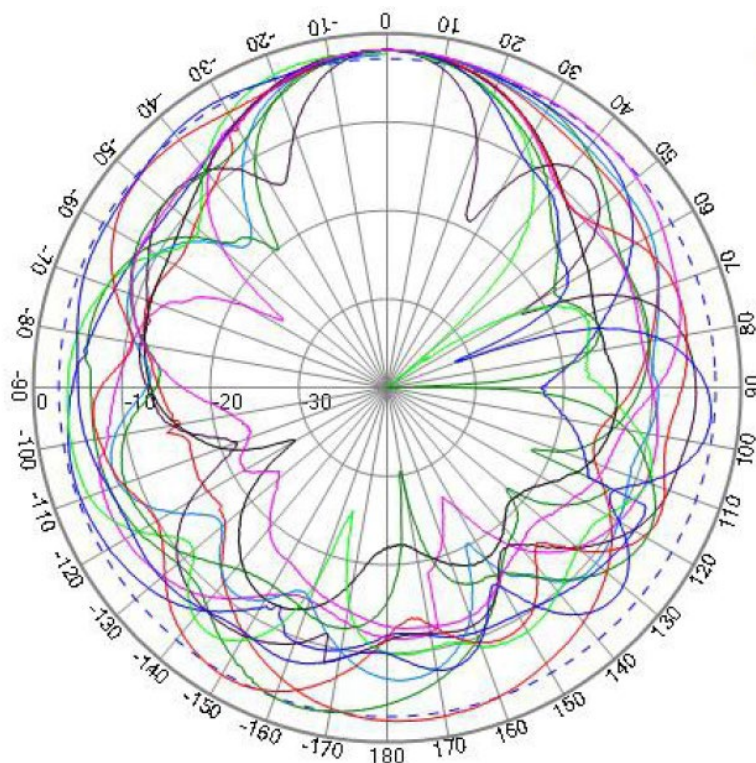

YZ PLANE

Freq: 700

Freq: 824

Freq: 868

Freq: 960

Freq: 1710

Freq: 1850

Freq: 1990

Freq: 2170

Freq: 2300

Freq: 2400

Freq: 2500

Freq: 2690