

Surface Mount Aluminum Electrolytic Capacitors NAWE Series

FEATURES

- CYLINDRICAL V-CHIP CONSTRUCTION FOR SURFACE MOUNTING
- SUIT FOR HIGH TEMPERATURE REFLOW SOLDERING (UP TO 260°C)
- 1,000 HOUR LOAD LIFE @ +105°C
- DESIGNED FOR AUTOMATIC MOUNTING AND REFLOW SOLDERING

SAC Alloy Compatible
230°C ~ 260°C

RoHS Compliant
includes all homogeneous materials



CHARACTERISTICS

Rated Voltage Rating	6.3 ~ 50Vdc					
Rated Capacitance Range	1.0 ~ 470µF					
Operating Temp. Range	-55 ~ +105°C					
Capacitance Tolerance	±20% (M)					
Max. Leakage Current After 2 Minutes @ 20°C	0.01CV or 3µA whichever is greater					
Tan δ @ 120Hz/20°C	W.V. (Vdc)	6.3	16	25	35	50
	S.V. (Vdc)	8.0	20	32	44	63
	4mm, 5mm diameter & 6.3x6.1mm 6.3x8mm & 8mm diameter	0.30	0.20	0.16	0.14	0.12
Low Temperature Stability Impedance Ratio @ 120Hz	W.V. (Vdc)	6.3	16	25	35	50
	Z-25°C/Z+20°C	4	2	2	2	2
	Z-40°C/Z+20°C	8	4	4	3	3
Load Life Test @ 105°C All Case Sizes = 1,000 hours	Capacitance Change	Within ±30% of initial measured value				
	Tan δ	Less than ±300% of the specified maximum value				
	Leakage Current	Less than the specified maximum value				

*See Part Number System for Details

LOW ESR COMPONENT
LIQUID ELECTROLYTE
For Performance Data see www.LowESR.com

STANDARD VALUES AND CASE SIZES (mm)

Cap. (µF)	Code	Working Voltage (Vdc)				
		6.3	16	25	35	50
1.0	1R0	-	-	-	-	4x5.5
2.2	2R2	-	-	-	-	4x5.5
3.3	3R3	-	-	-	-	4x5.5
4.7	4R7	-	-	-	4x5.5	5x5.5
10	100	-	4x5.5	-	5x5.5	6.3x5.5
22	220	4x5.5	5x5.5	-	6.3x5.5	-
33	330	-	-	6.3x5.5	-	-
47	470	-	6.3x5.5	-	-	-
100	101	6.3x5.5	6.3x5.5	-	-	8x10.5
220	221	-	-	8x10.5	-	-
330	331	-	8x10.5	-	-	-
470	471	8x10.5	-	-	-	-

PEAK REFLOW TEMPERATURE CODES

Code	Peak Reflow Temperature
N	260°C
L	250°C

TERMINATION FINISH & PACKAGING OPTIONS CODES

Code	Finish & Reel Size
B	Sn-Bi Finish & 13" Reel
LB	Sn-Bi Finish & 15" Reel
S	100% Sn Finish & 13" Reel
LS	100% Sn Finish & 15" Reel

PART NUMBER SYSTEM

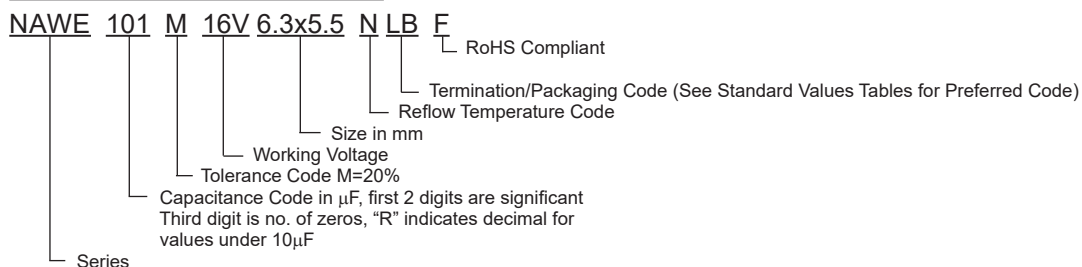

Surface Mount Aluminum Electrolytic Capacitors NAWE Series

STANDARD VALUES, CASE SIZES AND SPECIFICATIONS

NIC Part Number	Cap. (μF)	W.V. (Vdc)	Dissipation Factor (Tan δ)	Max. Ripple Current (mA) +105°C/120Hz	Load Life Hours @ +105°C
NAWE220M6.3V4X5.5N_F	22	6.3	0.30	23	1,000
NAWE101M6.3V6.3X5.5NBF	100		0.30	57	1,000
NAWE471M6.3V8X10.5L_F	470		0.35	210	1,000
NAWE100M16V4X5.5N_F	10	16	0.20	20	1,000
NAWE220M16V5X5.5NBF	22		0.20	31	1,000
NAWE470M16V6.3X5.5NBF	47		0.20	56	1,000
NAWE101M16V6.3X5.5NBF	100		0.20	65	1,000
NAWE331M16V8X10.5L_F	330		0.20	195	1,000
NAWE330M25V6.3X5.5NBF	33	25	0.16	48	1,000
NAWE221M25V8X10.5L_F	220		0.16	190	1,000
NAWE4R7M35V4X5.5N_F	4.7	35	0.14	14	1,000
NAWE100M35V5X5.5NBF	10		0.14	24	1,000
NAWE220M35V6.3X5.5NBF	22		0.14	46	1,000
NAWE1R0M50V4X5.5N_F	1.0	50	0.12	8.0	1,000
NAWE2R2M50V4X5.5N_F	2.2		0.12	11	1,000
NAWE3R3M50V4X5.5N_F	3.3		0.12	13	1,000
NAWE4R7M50V5X5.5NBF	4.7		0.12	18	1,000
NAWE100M50V6.3X5.5NBF	10		0.12	28	1,000
NAWE101M50V8X10.5L_F	100		0.12	200	1,000

Part Number Suffix Where _ _ : Preferred (15" reel) = LB, Legacy (13" reel) = B (check with NIC for availability)

RIPPLE CURRENT FREQUENCY CORRECTION FACTORS

Frequency	50/60Hz	120Hz	500Hz	1KHz	10KHz
1μF	0.5	1.00	1.20	1.30	1.50
2.2 ~ 4.7μF	0.65	1.00	1.20	1.30	1.50
10 ~ 47μF	0.80	1.00	1.20	1.30	1.50
100 ~ 470μF	0.80	1.00	1.10	1.15	1.20

DIMENSIONS (mm) AND REEL QUANTITIES

Case Size	φD±0.5	L max.	A±0.2	B±0.2	l±0.3	W	P±0.3	Qty/Reel
4x5.5	4.0	5.5	4.3	4.3	1.8	0.5~0.8	1.0	1,500
5x5.5	5.0	5.5	5.3	5.3	2.2	0.5~0.8	1.4	1000
6.3x5.5	6.3	5.5	6.6	6.6	2.5	0.5~0.8	2.2	1000
8x10.5	8.0	10.5	8.3	8.3	2.9	0.7~1.1	3.2	300

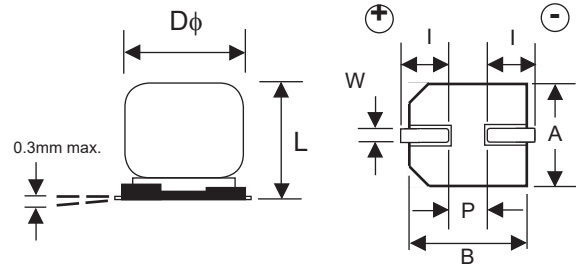

PRECAUTIONS

Please review the notes on correct use, safety and precautions found at <https://www.niccomp.com/resource/files/aluminum/AlumApplInfoCautions.pdf>
 If in doubt or uncertainty, please review your specific application - process details with NIC's technical support personnel: tpmg@niccomp.com

Surface Mount Aluminum Electrolytic Capacitors NAWE Series

PEAK REFLOW TEMPERATURE AND DURATION

Diameter	Time above 217°C	Peak Temperature 5 seconds
4 ~ 6.3mm ϕ	60 sec. max.	260°C
8mm ϕ	60 sec. max.	250°C

Capacitors can withstand two times reflow at the above conditions. Second reflow shall be at least one hour after natural cool to room temperature.

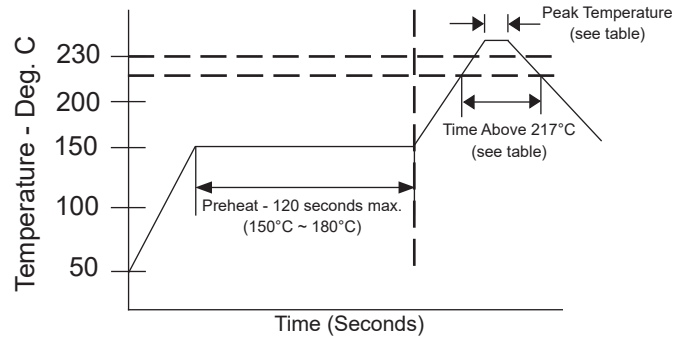

RECOMMENDED LAND PATTERN DIMENSIONS (mm)

Case Size	a	b	c
4x5.5	1.0	2.6	1.8
5x5.5	1.4	3.0	1.8
6x3x5.5	1.8	3.6	1.8
8x10.5	2.8	4.1	2.2

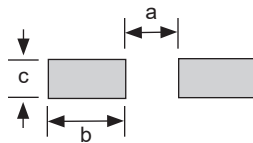

Review & Compare Reflow Soldering Heat Limits
V-chip SMT Aluminum Electrolytic Capacitors
www.niccomp.com/RSL

CARRIER TAPE DIMENSIONS & REEL QTY

Case Size	A ±0.5	B ±0.5	C ±0.3	D ±0.1	P ±0.1	T ±0.2	t ±0.1
4x5.5	4.7	4.7	12.0	5.5	8.0	5.8	0.6
5x5.5	5.7	5.7	12.0	5.5	12.0	5.8	0.6
6.3x5.5	7.0	7.0	16.0	7.5	12.0	5.8	0.6
8x10.5	8.7	8.7	24.0	11.5	16.0	11.1	0.6

Surface Mount Aluminum Electrolytic Capacitors NAWE Series

Preferred V-Chip 15" (380mm) Reels (LB suffix)

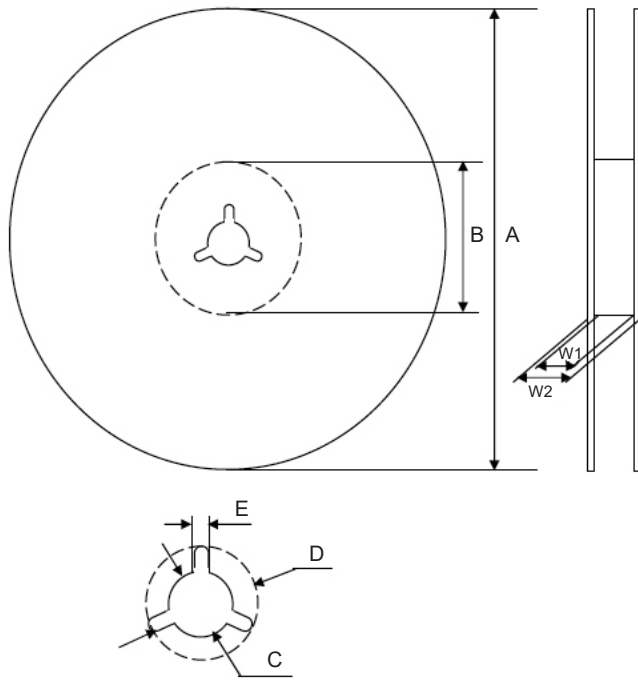

Dimensions (mm)

Case Size	Tape Width	W1	W2
4x5.5	12.0	12.5 ~ 14.0	15.5 ~ 20.0
8x10.5	24.0	24.5 ~ 26.0	27.5 ~ 32.0

Case Size	Tape Width	A	B	C	D	E
4x5.5	12.0	$\phi 380$	$\phi 80 \sim 105$	$\phi 13$	$\phi 21$	2.0
8x10.5	24.0	± 2		± 0.5	± 1.0	± 0.5

Color
Black or Blue

Optional V-Chip 13" (330mm) Reels (B suffix)

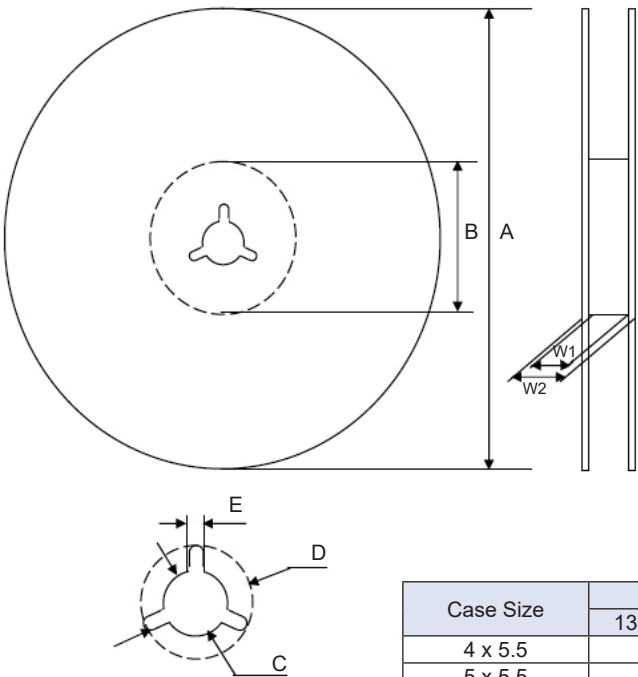

Dimensions (mm)

Case Size	Tape Width	W1	W2
4x5.5, 5x5.5	12.0	12.4 ~ 14.4	15.5 ~ 20.0
6.3x5.5	16.0	16.4 ~ 18.4	19.5 ~ 24.0
8x10.5	24.0	24.4 ~ 26.4	27.5 ~ 32.0

Case Size	Tape Width	A	B	C	D	E
4x5.5	12.0	$\phi 330$	$\phi 50 \sim 105$	$\phi 13$	$\phi 21$	2.0
6.3x5.5	16.0	± 2.0		± 0.5	± 1.0	± 0.5
8x10.5	24.0					

Color
Black or Blue

Case Size	Quantity Per Reel	
	13" (330mm) Reel	15" (380mm) Reel
4 x 5.5	1,500 pcs	2,000 pcs
5 x 5.5	1,000 pcs	N/A
6.3 x 5.5	1,000 pcs	N/A
8 x 10.5	300 pcs	500 pcs